

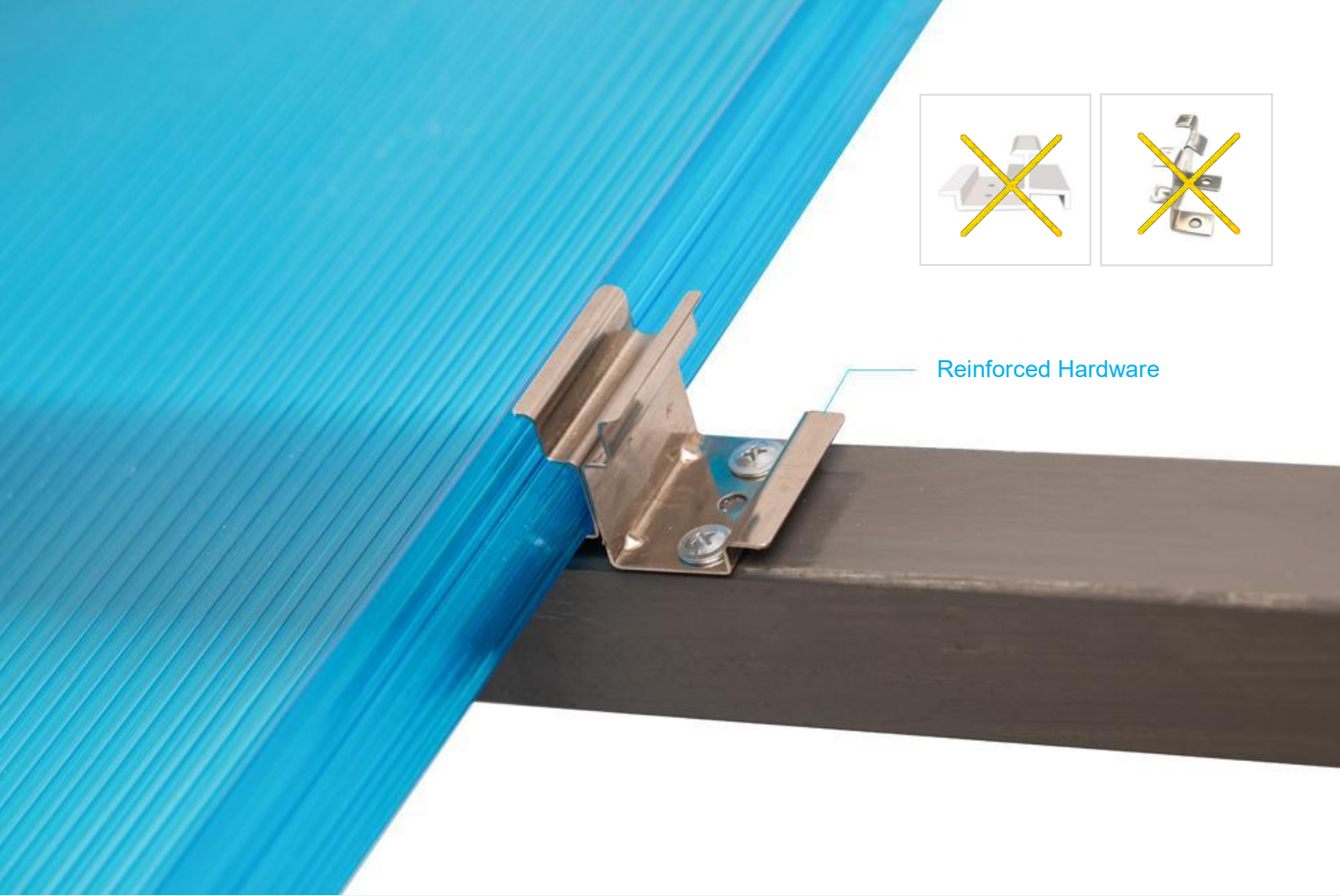

## U - System roof







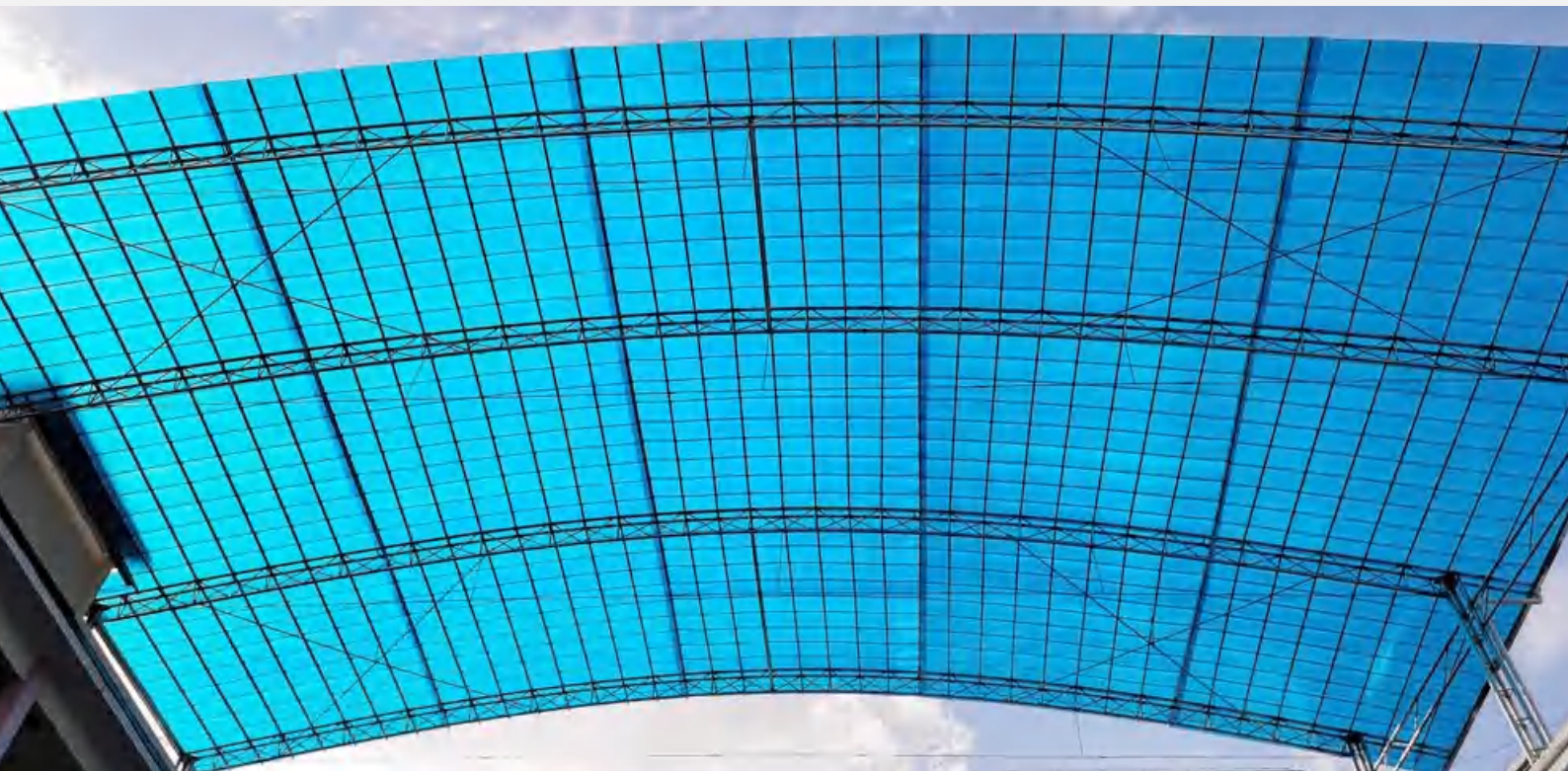

Reinforced Hardware

U - System roof Made from polycarbonate raw materials (Covestro or SABIC) , Do not use recycled raw materials. UV coating, improving service life, with a 10-year quality guarantee. It can avoid tearing caused by thermal expansion and is suitable for building large-span canopy. Multiple colors can be selected, the light transmittance can be adjusted, and there is thermal insulation function.

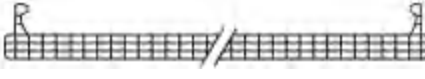

## Size and performance

| Mold                                                                                    | Structure   | Thickness (mm) | Width (mm) | Length     | Insulation coefficient W/m <sup>2</sup> ·K | Soundproof (dB) | minimum bend radius (mm) |
|-----------------------------------------------------------------------------------------|-------------|----------------|------------|------------|--------------------------------------------|-----------------|--------------------------|
| 1#<br> | Double Wall | 6              | 600        | customized | 3.2                                        | 12              | 1200                     |
|                                                                                         |             | 8              |            |            | 3.1                                        | 16              | 1600                     |
|                                                                                         |             | 10             |            |            | 3.0                                        | 20              | 2000                     |
| 2#<br> | Four walls  | 12             |            |            | 2.5                                        | 21              | 2400                     |
|                                                                                         |             | 16             |            |            | 2.3                                        | 24              | 3200                     |
| 3#<br> | Four walls  | 8              |            |            | 2.7                                        | 17              | 1600                     |
|                                                                                         |             | 10             |            |            | 2.6                                        | 21              | 2000                     |
|                                                                                         |             | 12             |            |            | 2.5                                        | 21              | 2400                     |
| 4#<br> | Alveolate   | 8              |            |            | 2.7                                        | 17              | 1600                     |
|                                                                                         |             | 10             |            |            | 2.6                                        | 21              | 2000                     |
|                                                                                         |             | 12             |            |            | 2.5                                        | 21              | 2400                     |

## Span and load

| Spacing \ Load | 75KG/m <sup>2</sup> | 100KG/m <sup>2</sup> | 125KG/m <sup>2</sup> | 150KG/m <sup>2</sup> | 175KG/m <sup>2</sup> | 200KG/m <sup>2</sup> |
|----------------|---------------------|----------------------|----------------------|----------------------|----------------------|----------------------|
| Thicknes       |                     |                      |                      |                      |                      |                      |
| 6mm            | 0.95 M              | 0.8 M                | 0.65 M               | /                    | /                    | /                    |
| 8mm            | 1.1 M               | 0.95 M               | 0.8 M                | 0.7 M                | 0.6 M                | 0.5 M                |
| 10mm           | 1.25 M              | 1.1 M                | 0.95 M               | 0.85 M               | 0.75 M               | 0.65 M               |
| 12mm           | 1.3 M               | 1.15M                | 1 M                  | 0.9 M                | 0.8 M                | 0.7 M                |
| 16mm           | 1.35 M              | 1.2 M                | 1.1 M                | 1 M                  | 0.9 M                | 0.8 M                |



\*For your reference only

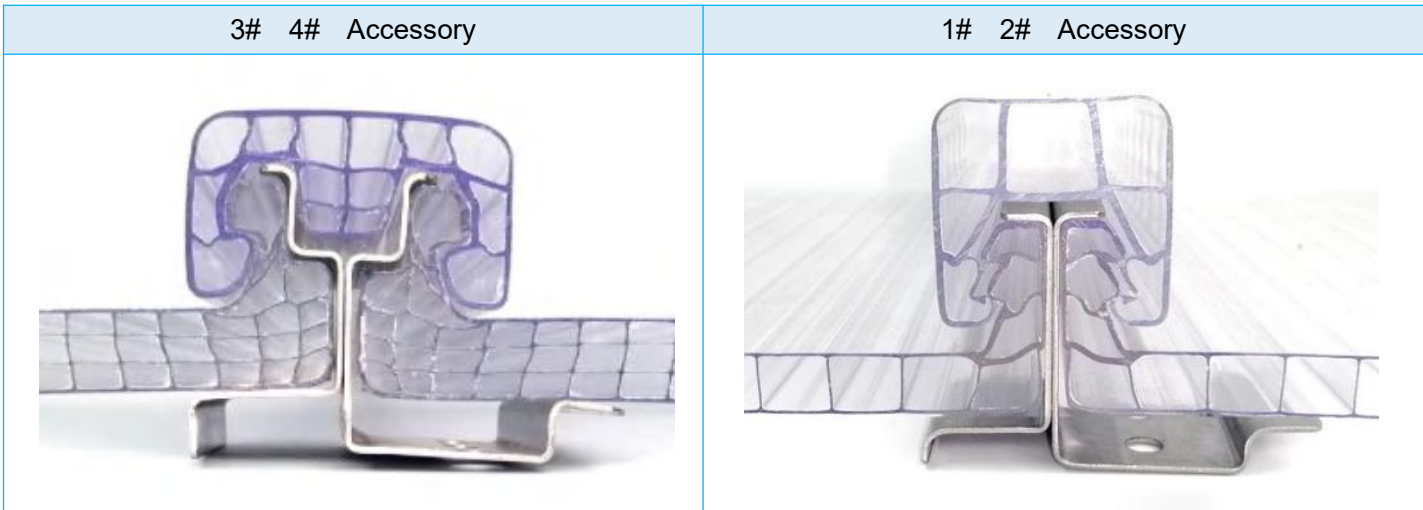

| Model            | No.                                      | Picture                                                                             | Model            | No.                                                                   | Picture                                                                               |
|------------------|------------------------------------------|-------------------------------------------------------------------------------------|------------------|-----------------------------------------------------------------------|---------------------------------------------------------------------------------------|
| PC profiles      | AC101                                    |    | PC profiles      | AC102                                                                 |    |
| Plastic          | AC201                                    |   | Plastic          | AC202                                                                 |   |
| Stainless steel  | AC308(8mm)<br>AC310(10mm)<br>AC312(12mm) |  | Stainless steel  | AC406(6mm)<br>AC408(8mm)<br>AC410(10mm)<br>AC412(12mm)<br>AC416(16mm) |  |
| Screw            | AC501                                    |  | Screw            | AC501                                                                 |  |
| PC profiles      | AC608(8mm)<br>AC610(10mm)<br>AC612(12mm) |  | PC profiles      | AC706(6mm)<br>AC708(8mm)<br>AC710(10mm)<br>AC712(12mm)                |  |
|                  |                                          |                                                                                     | Aluminum profile | AC816(16mm)                                                           |  |
| Aluminum Tape    | AC901                                    |  | Aluminum Tape    | AC901                                                                 |  |
| Waterproof screw | AC502                                    |  | Waterproof screw | AC502                                                                 |  |



1. Four corner slots of the board (reserved gaps for U-shaped profiles)



2. Stick aluminum tape/breathable tape on both ends, remove the bottom film of the board

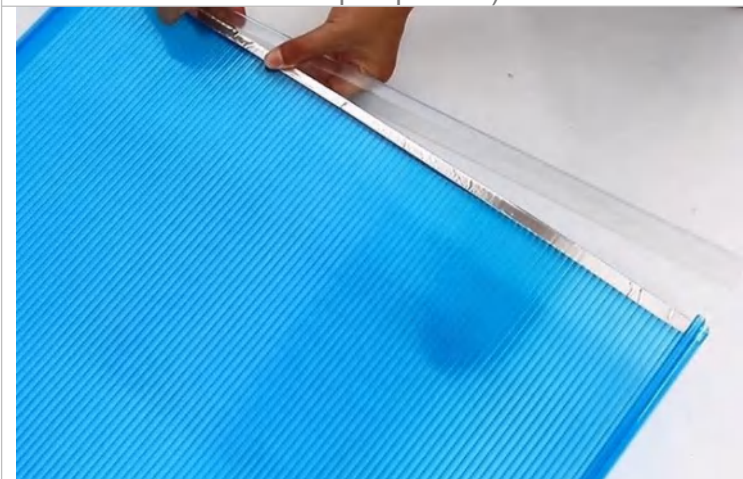

3. Install U-shaped profiles at both ends

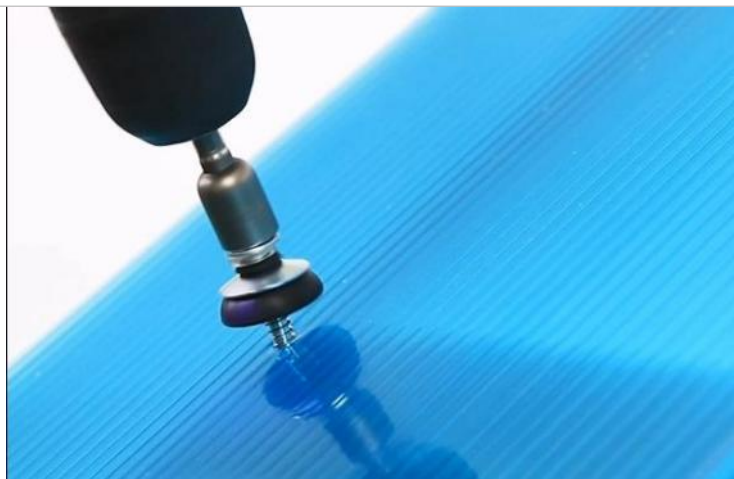

4. Fix the edge of the first board with screws

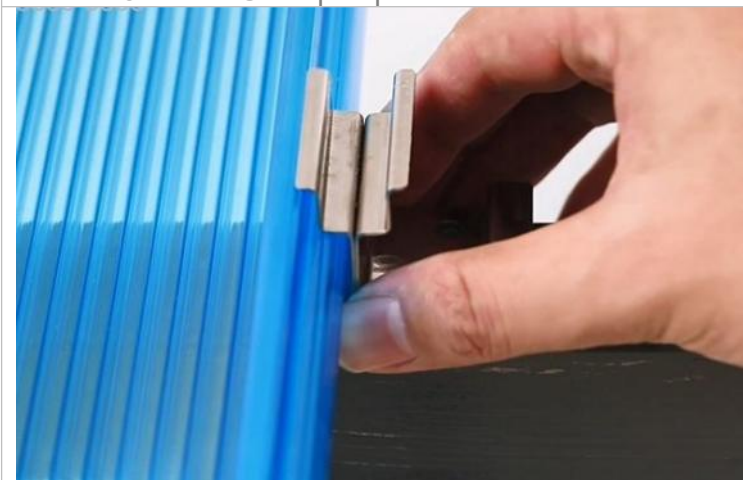

5. Place metal fasteners

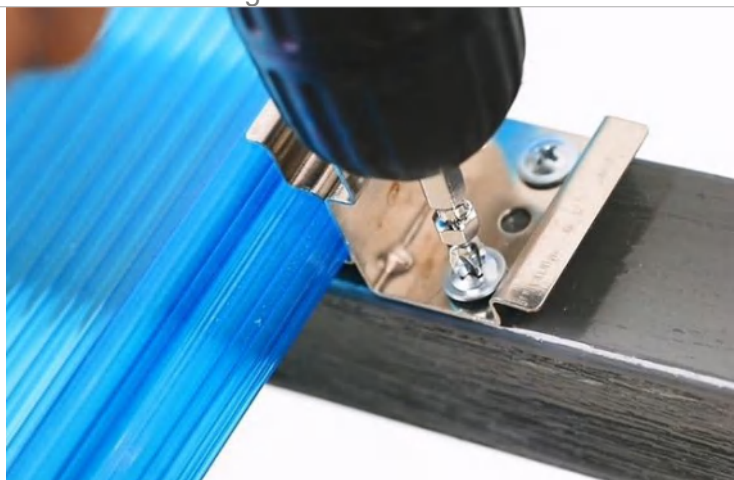

6. Screw fixed metal fasteners



7. Install the second board



8. Install the pressure strip to connect the two boards



9. Install end caps

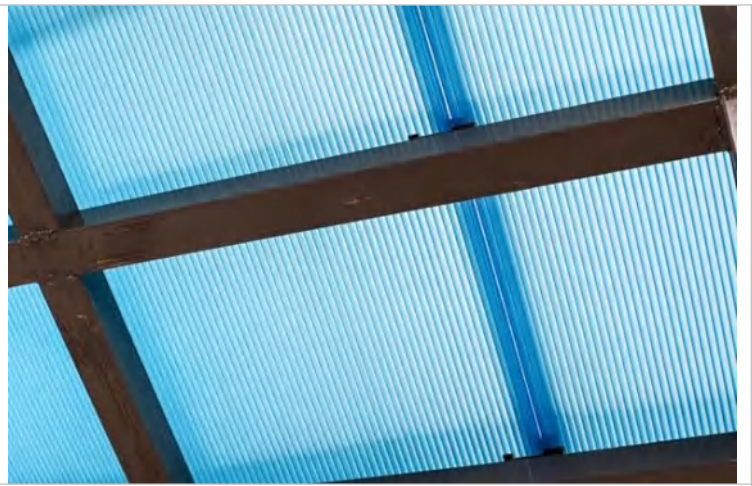

10. Remove the film on the board

■ Fixed around the canopy:

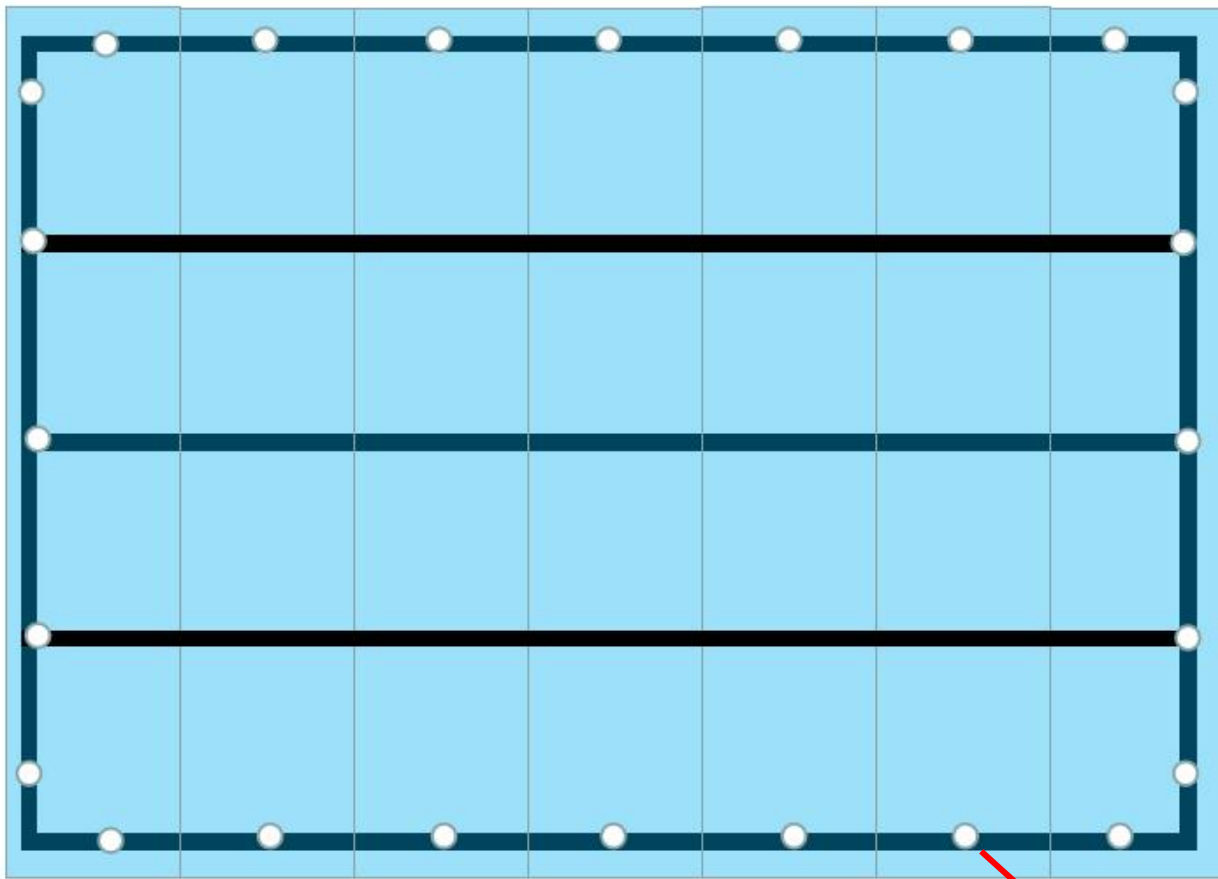

0.6M

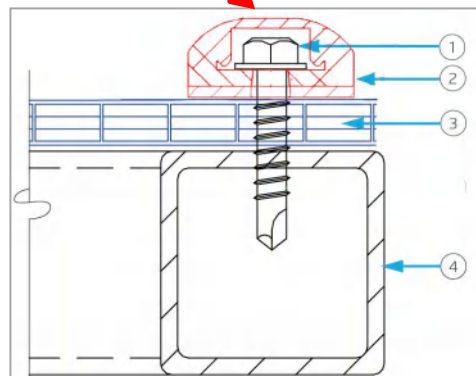

- ① Self tapping screw
- ② waterproof gasket
- ③ U-shaped locking plate
- ④ purlin

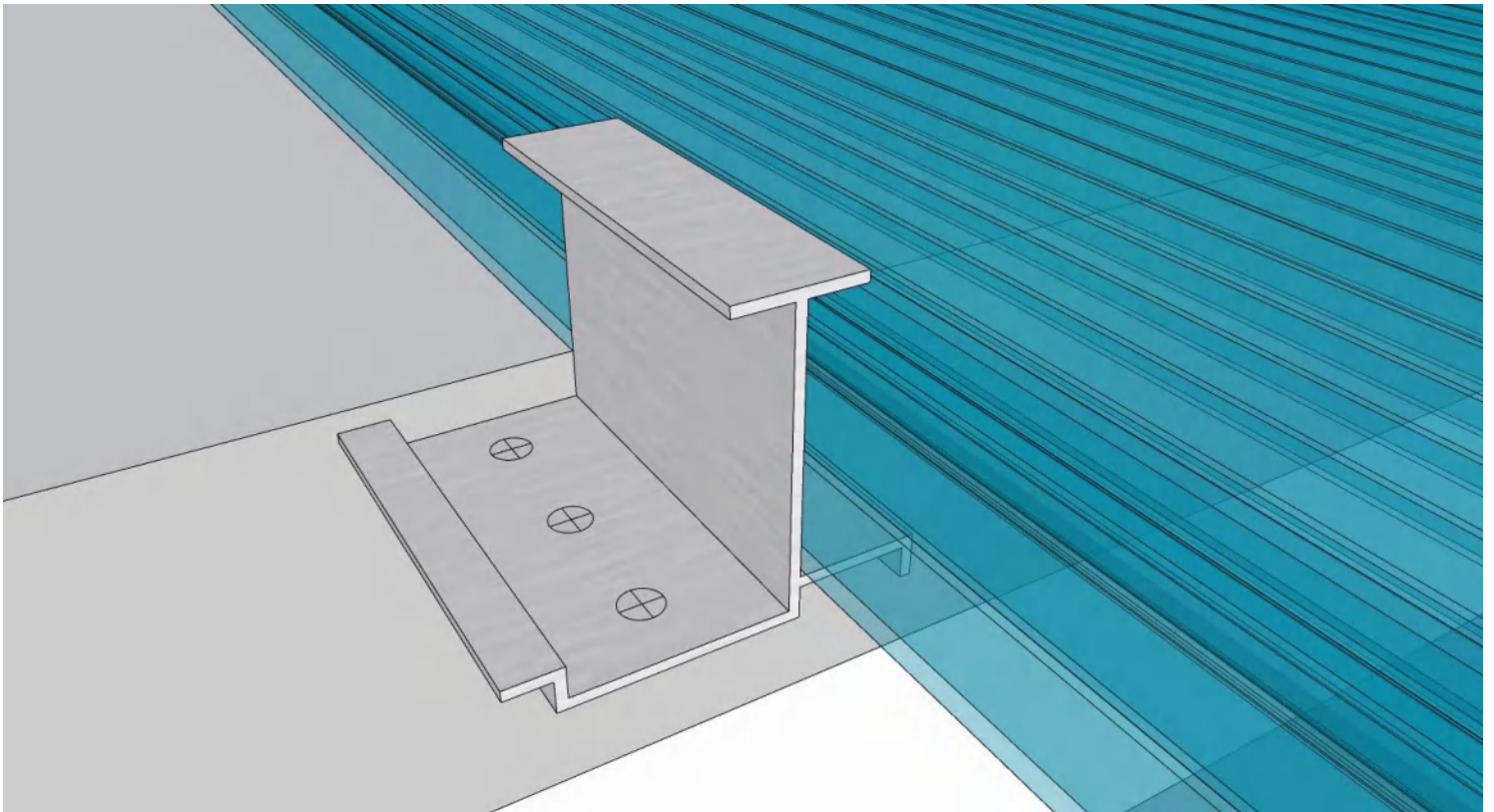
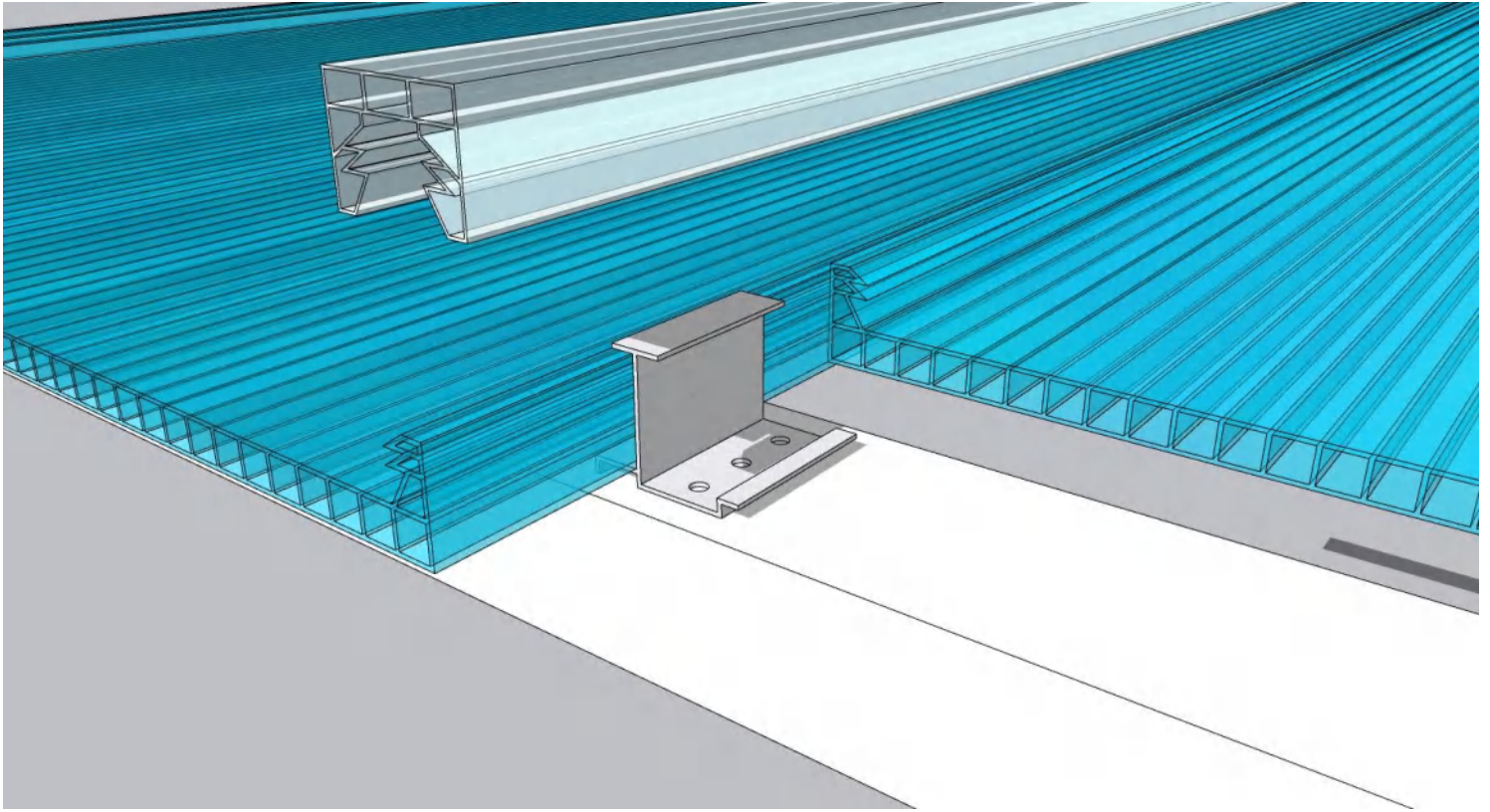

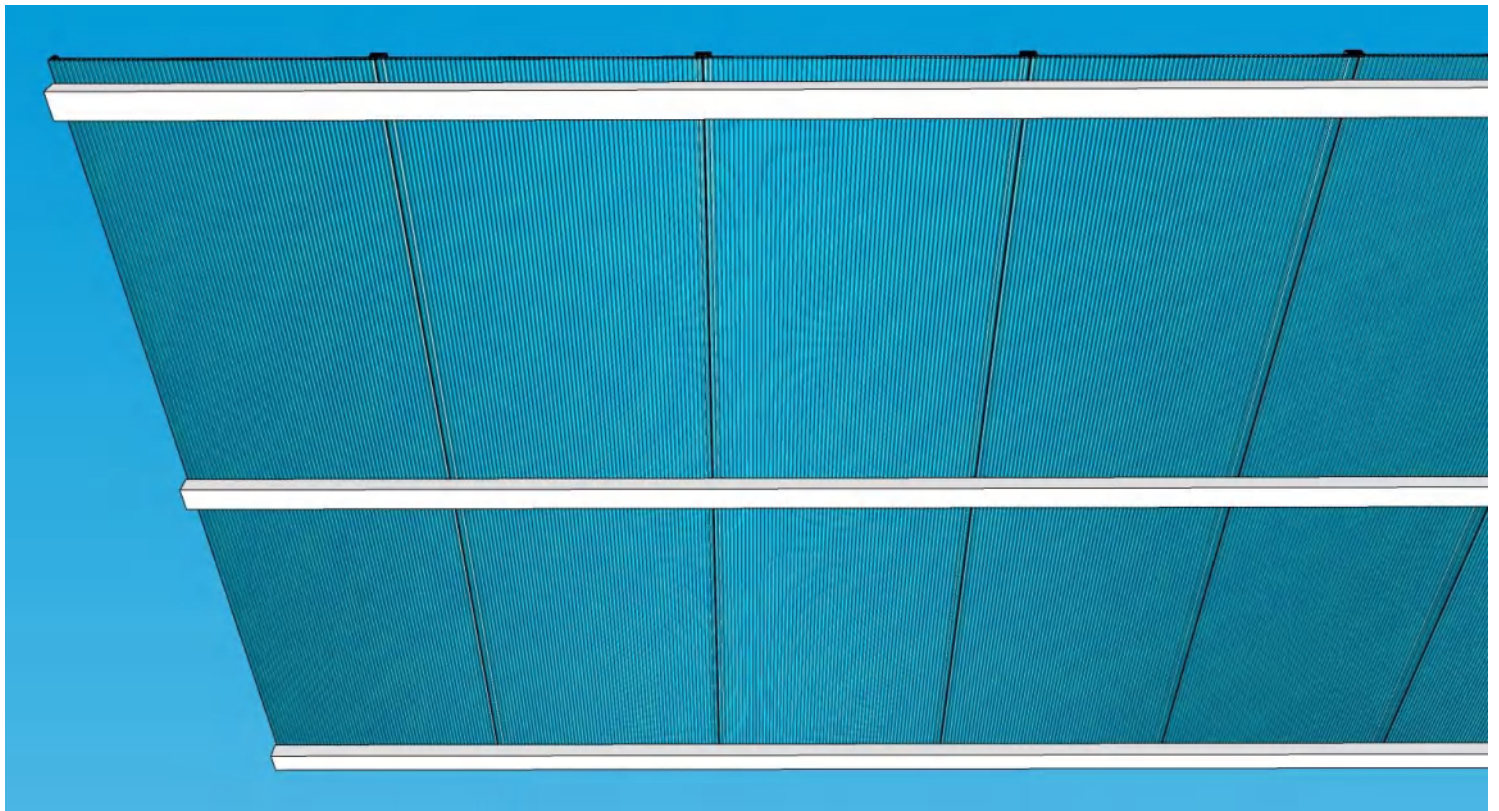
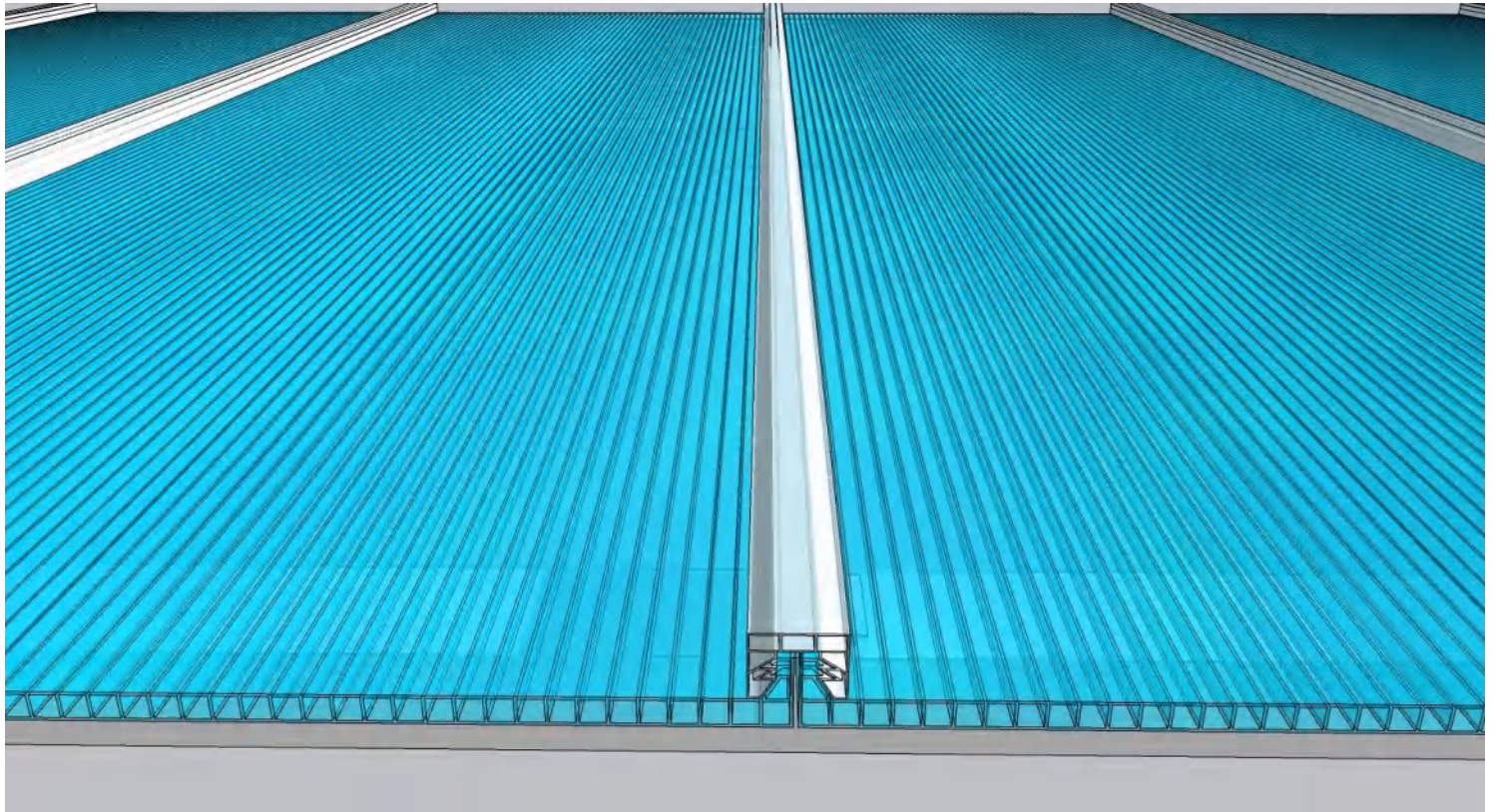





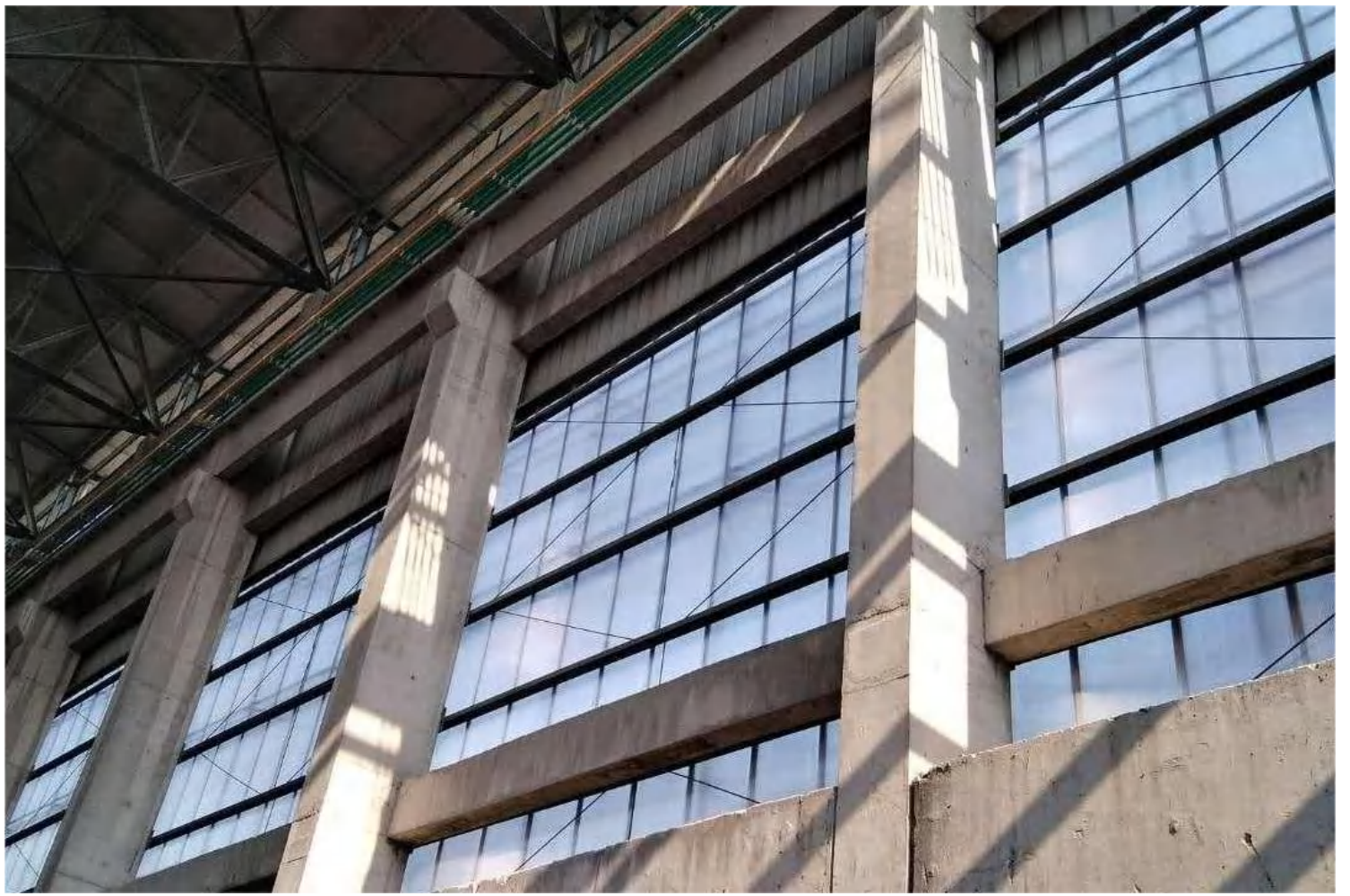







E-Mail: [polycarbonatesheet@qq.com](mailto:polycarbonatesheet@qq.com)